

STANDARD FOOT IN STAINLESS STEEL CAPACITY: 2000 KG TO 5000 KG

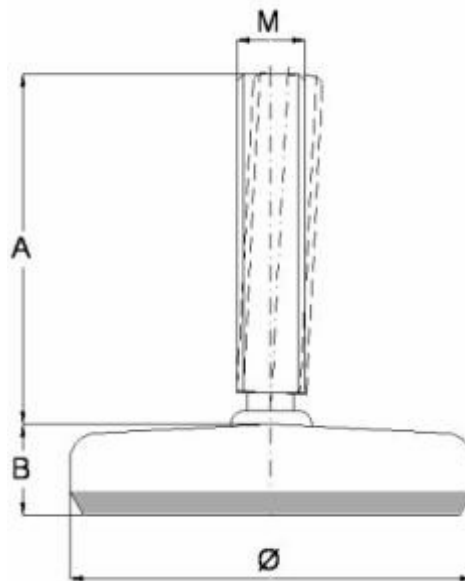

Model DT 10



DIMENSIONS

LOWER PART	DT 75	DT 125
Ø DIAMETER	75 mm	125 mm
A MEASURE	50 mm	100 mm
B MEASURE	22 MM	37 MM
THREAD	M12	M20
CAPACITY	2000 KG	5000 KG

OTHER THREADS AND LENGTH OF THREADED RODS ARE AVAILABLE